



www.sennheiser.com/documentation



www.sennheiser.com/download

Sennheiser electronic SE & Co. KG

Am Labor 1, 30900 Wedemark, Germany
www.sennheiser.com

Publ. 04/26, 587477/A03



MKE 600

Quick Guide

Kurzanleitung
Guide de démarrage rapide
Guida rapida
Instrucciones resumidas
Instruções resumidas
Beknopte gebruiksaanwijzing
Krótka instrukcja obsługi
Snabbguide

Kort vejledning

Pikaohje
Σύντομες οδηγίες
Kısa Kılavuz
Краткая инструкция
快速指南
快速使用指南
クイックガイド
요약 안내서

SENNHEISER

In the box

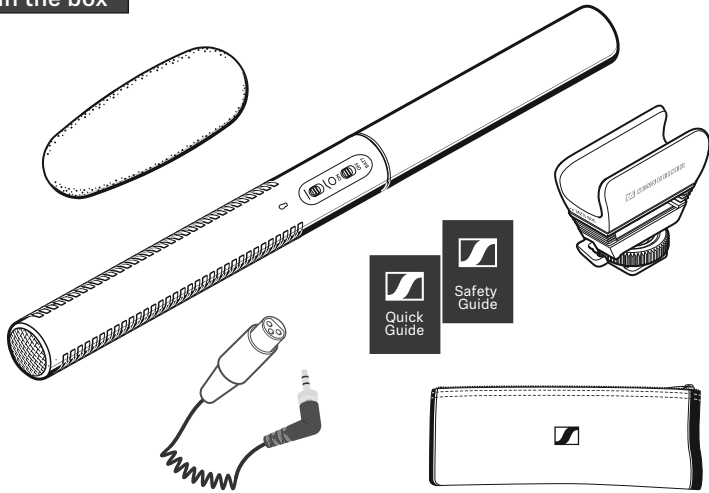

Overview

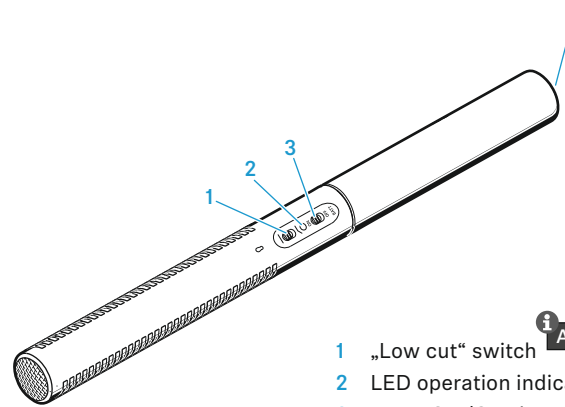

- Adjusting**
- 1 „Low cut“ switch
 - 2 LED operation indicator
 - 3 BATT ON/OFF battery switch
 - 4 XLR-3 socket

Battery

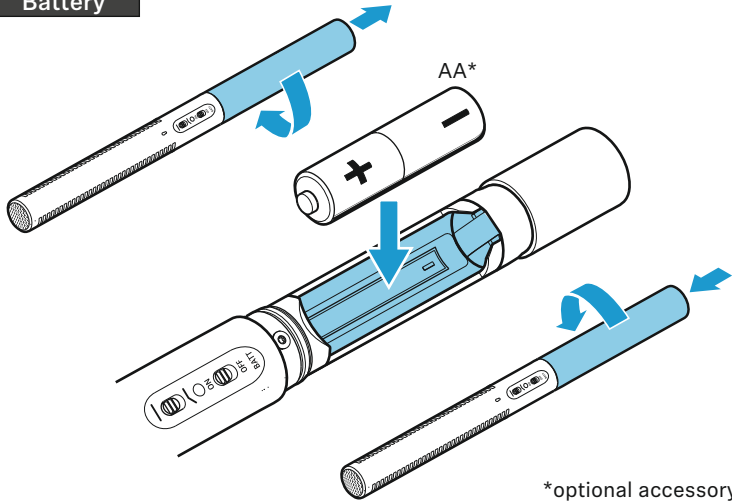

*optional accessory

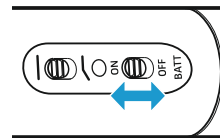

ON	OFF	BATT	On
ON	OFF	BATT	Off

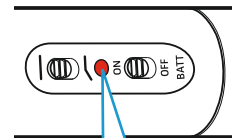

< 1s			0 h
			> 8 h
1s			150 h

Phantom powering

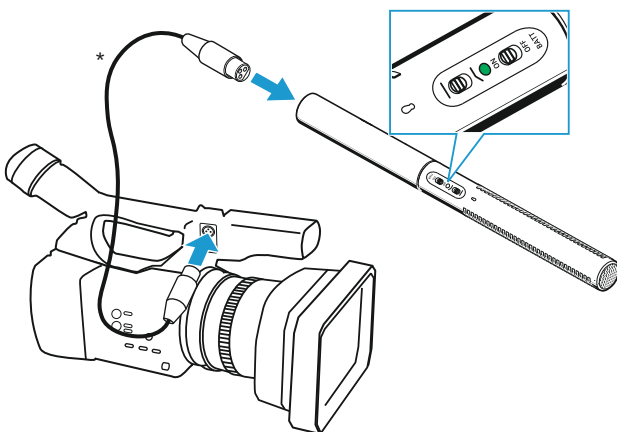

*optional accessory

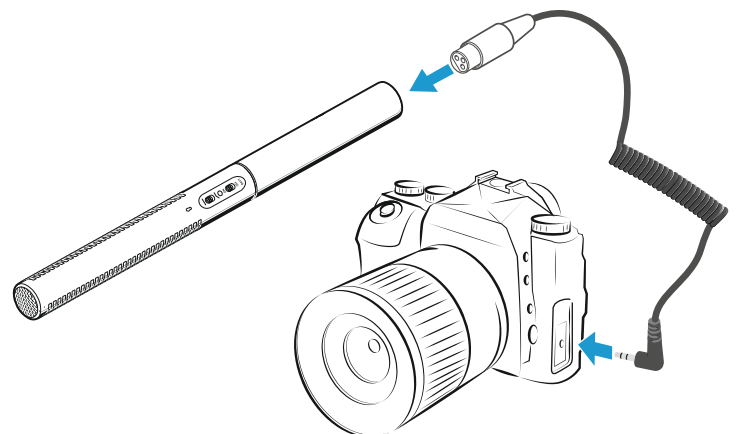

Setup

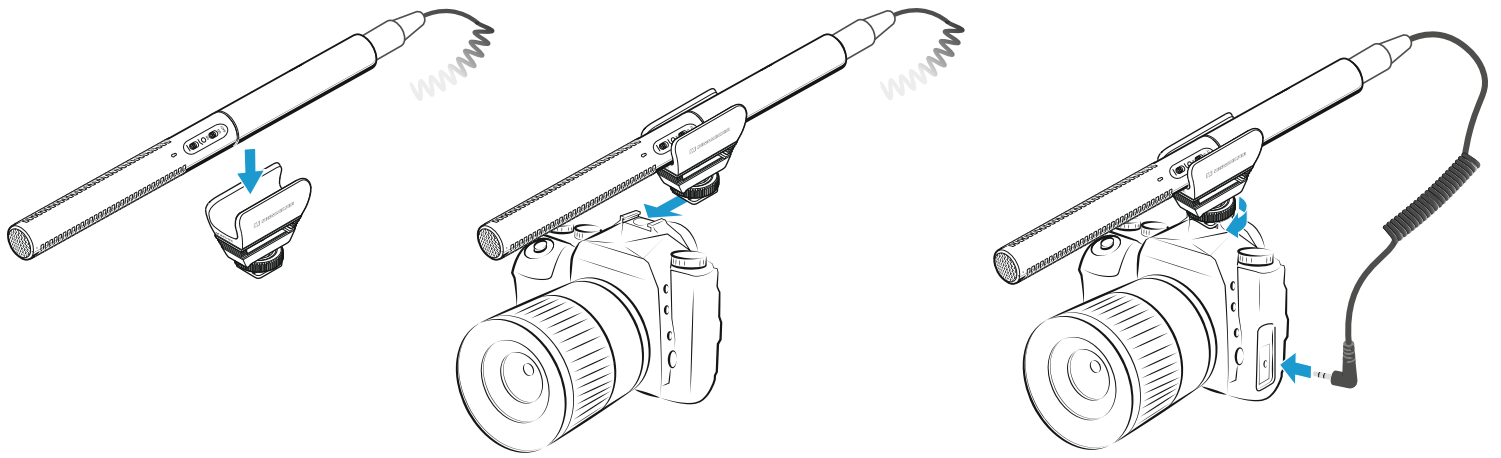

Adjusting

low-cut

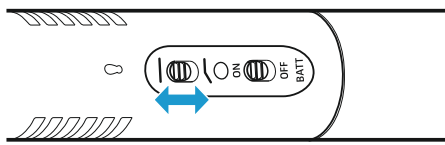

Off



On: frequencies below 100 Hz are attenuated to reduce wind and impact noise

Accessory

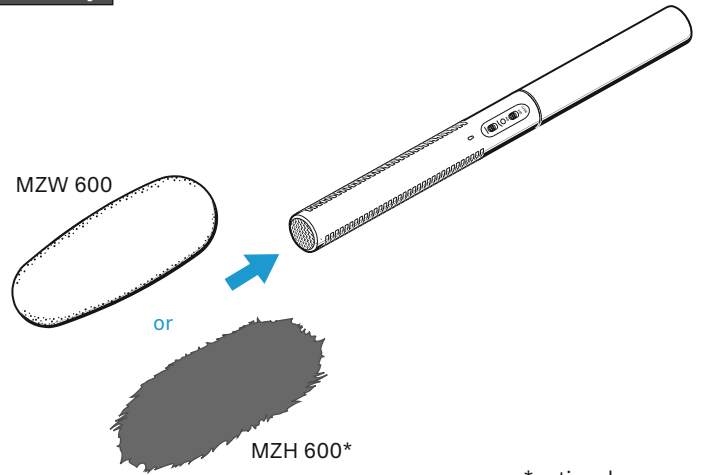

*optional accessory

Specifications

Pick-up pattern	super-cardioid/lobar
Frequency response	40 – 20,000 Hz
Sensitivity	with P48 powering: 21 mV/Pa with battery powering: 19 mV/Pa
Max. SPL	with P48 powering: 132 dB SPL with battery powering: 126 dB SPL
Equivalent noise level A-weighted	with P48 powering: 15 dB (A) with battery powering: 16 dB (A)
Power supply	48 V ± 4 V (P48, IEC 61938) via XLR-3 or battery/rechargeable battery (AA size, 1.5 V/1.2 V)
Current consumption	with P48 powering: 4.4 mA
Operating time with battery	approx. 150 h
„Low Batt“ indicator	< 1.05 V; approx. 8 h of remaining operating time after initial display
Temperature range	Operation: -10 °C to +60 °C
Dimension	∅ 20 mm x 256 mm
Weight	128 g (without battery)

Cleaning

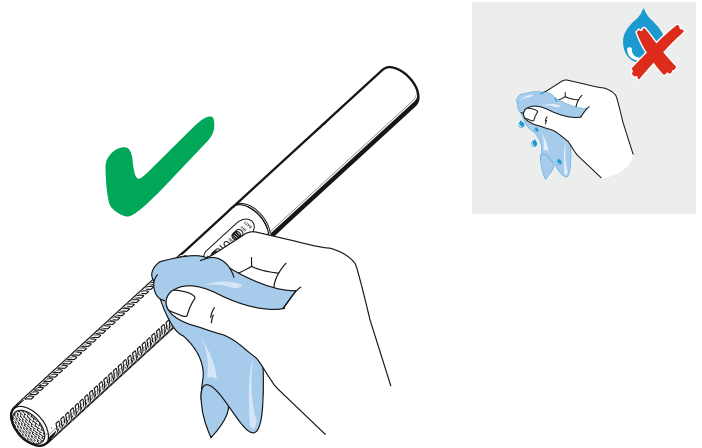

Polar pattern and frequency response

