



[www.sennheiser.com/documentation](http://www.sennheiser.com/documentation)



[www.sennheiser.com/download](http://www.sennheiser.com/download)



# MM 435

Quick Guide  
 Kurzanleitung  
 Guide de démarrage rapide  
 Guida rapida  
 Instrucciones resumidas  
 Instruções resumidas  
 Beknopte gebruiksaanwijzing  
 Krótka instrukcja obsługi  
 Snabbguide

Kort vejledning  
 Pikaohje  
 Γρήγορος οδηγός  
 Kısa Kılavuz  
 Краткая инструкция  
 快速指南  
 快速使用指南  
 クイックガイド  
 퀵 가이드

## SENNHEISER

Sennheiser electronic SE & Co. KG

Am Labor 1, 30900 Wedemark, Germany  
[www.sennheiser.com](http://www.sennheiser.com)

Publ. 04/26, 583915/A05

### Setup

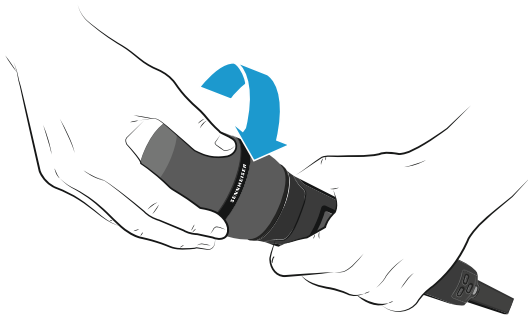
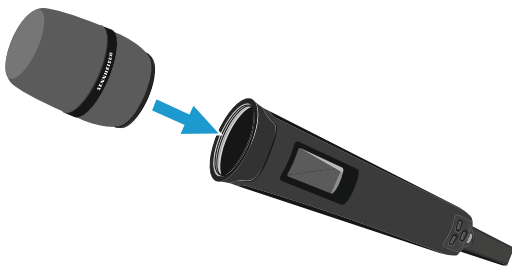

### In the box

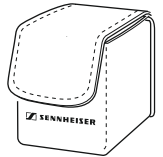

1 x Protective cap



5 x Pop shield

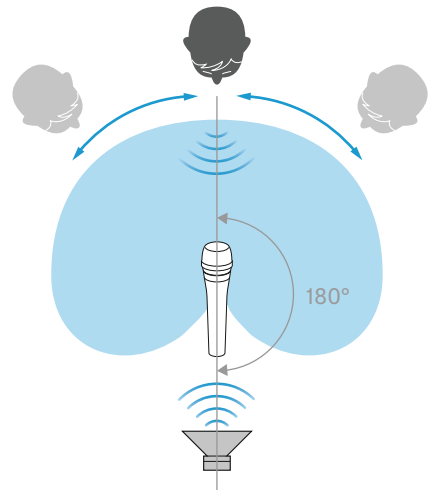

## Accessories



MZW 4032 / MZW 1

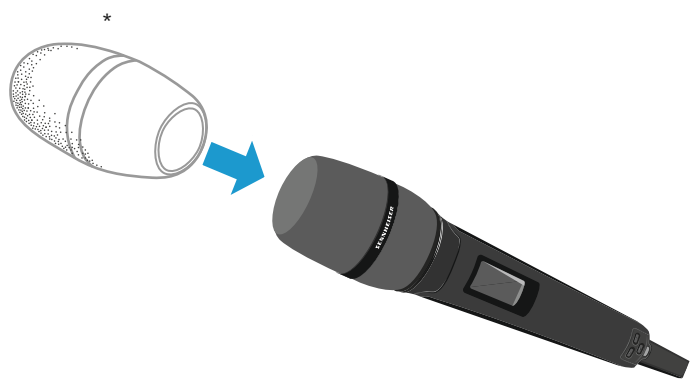
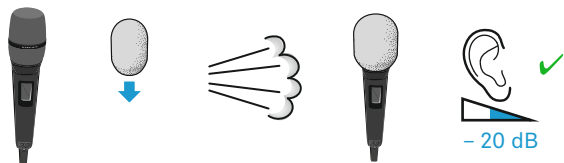

\*MZW 4032 / MZW 1 not included

## Cleaning

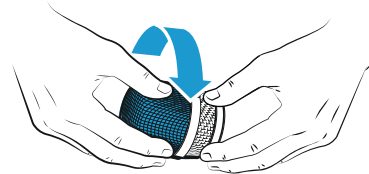
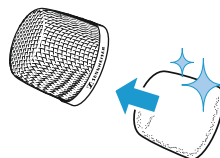
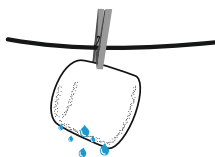
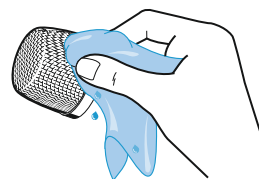
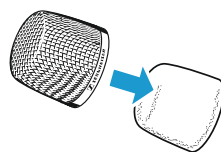
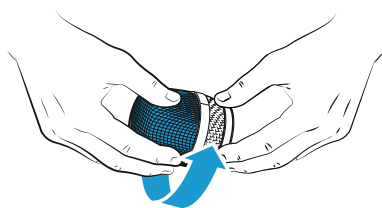

## Specifications

Transducer principle	dynamic
Frequency response	40 - 20,000 Hz
Pick-up pattern	cardioid
Sensitivity (free field, at 1 kHz)	1.8 mV/Pa
Max SPL at 1 kHz	163 dB
Dynamic range	146 db (A)
Dimensions	∅ 51 x 72.5 mm
Weight	119 g

## Compatible with

ew G4:	SKM 300, SKM 500
2000 series:	SKM 2000
Digital 6000:	SKM 6000
Digital 9000:	SKM 9000

## Polar pattern and frequency response

