

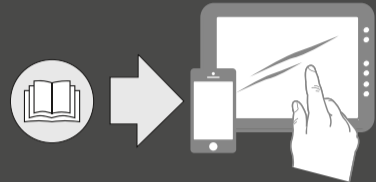

ACA 3

- Quick Guide
 - Kurzanleitung
 - Guide de démarrage rapide
 - Guida rapida
 - Instrucciones resumidas
 - Instruções resumidas
 - Beknopte gebruiksaanwijzing
 - Krótką instrukcja obsługi
 - Snabbguide
- Kort vejledning
 - Pikaohje
 - Γρήγορος οδηγός
 - Kisa Kilavuz
 - Краткая инструкция
 - 快速指南
 - 快速使用指南
 - クイックガイド
 - 퀵 가이드

SENNHEISER



Sennheiser Documentation App



ANDROID APP ON Google play

Available on the App Store

or online at www.sennheiser.com/download
ACA 3_

Sennheiser electronic GmbH & Co. KG

Am Labor 1, 30900 Wedemark, Germany
www.sennheiser.com

Printed in Germany, Publ. 10/19, 583927/A01

ACA 3

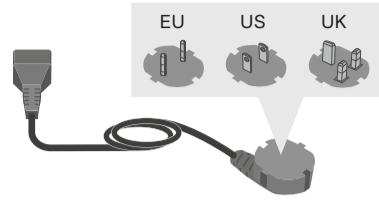

Operating elements

Front

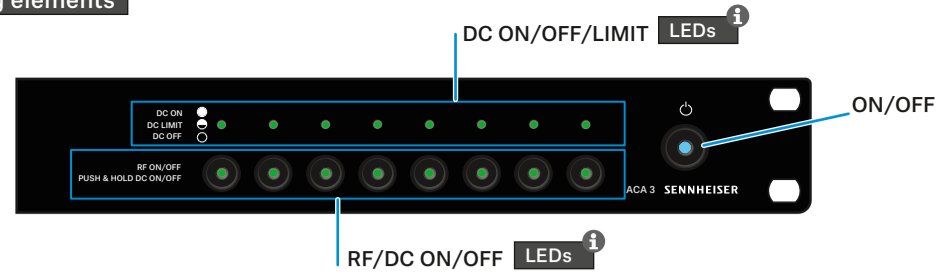

Back

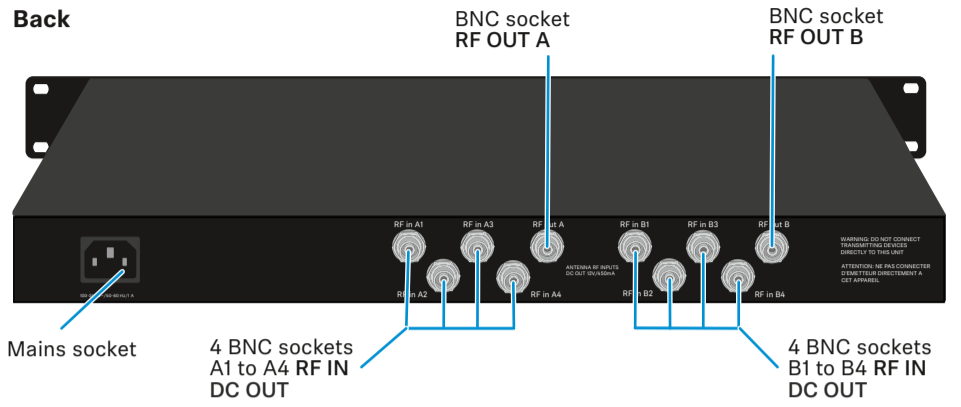

Setup

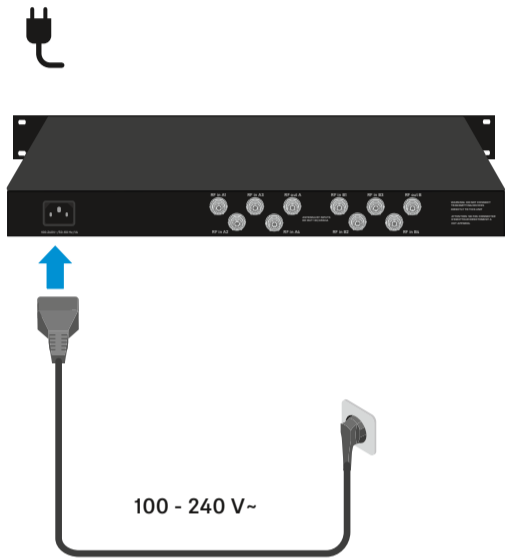

ON/OFF

ON/Standby

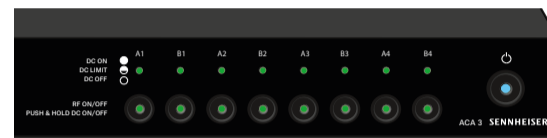

	short	long
ACA 3	on	standby
LED	on	blinking
LED RF	by memory	off
LED DC	by memory	off

OFF

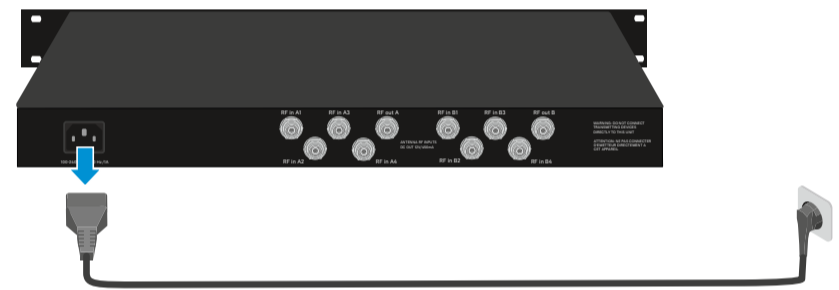

Specifications

Frequency range	470 - 798 MHz
Gain	0 dB (±3 dB) @ 470-790 MHz
Output voltage	12 V, 250 mA max (overload protected)
Connector	BNC female, 50 "
Power supply	100-240 V~/ 50-60 Hz / 1A
RF input	+10 dBm max 10 mW / channel
RF output	IP3: >37 dBm (typ.); 1 dB cp: >20 dBm
Specials	Channel isolation (when switched OFF): 69 dB (typ.)
Operating relative humidity	5 to 95%
Operating temperature range	-10 °C to +40 °C
Storage temperature range	-20 °C bis +70 °C
Dimensions (incl. rack mount ears)	approx. 43 x 483 x 205 mm
Format	19 inch, 1U
Weight (incl. plug, cable)	approx. 2750 g

Operating modes

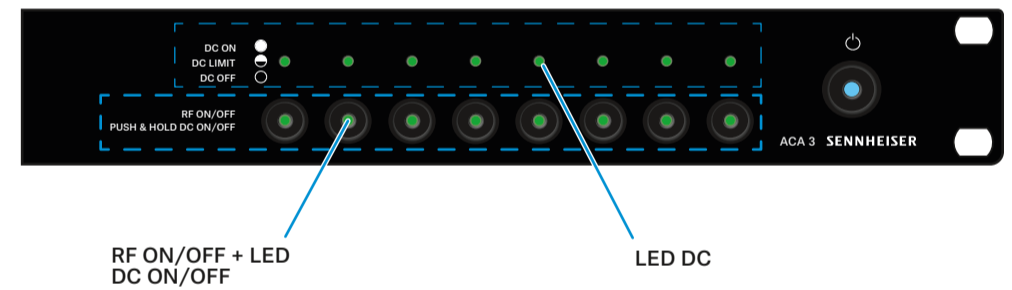

	short	long
RF	on/off	-
DC	-	on/off

LEDs	DC	RF
on	✓	✓
blinking	LIMIT	-
off	✗	✗

Setup

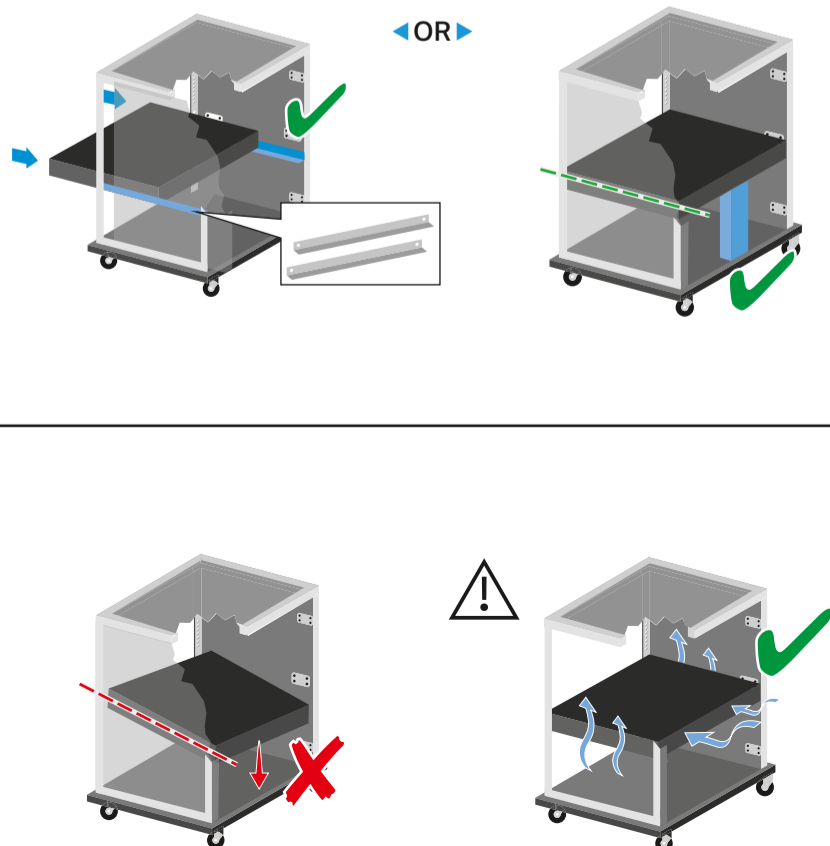

Connecting devices

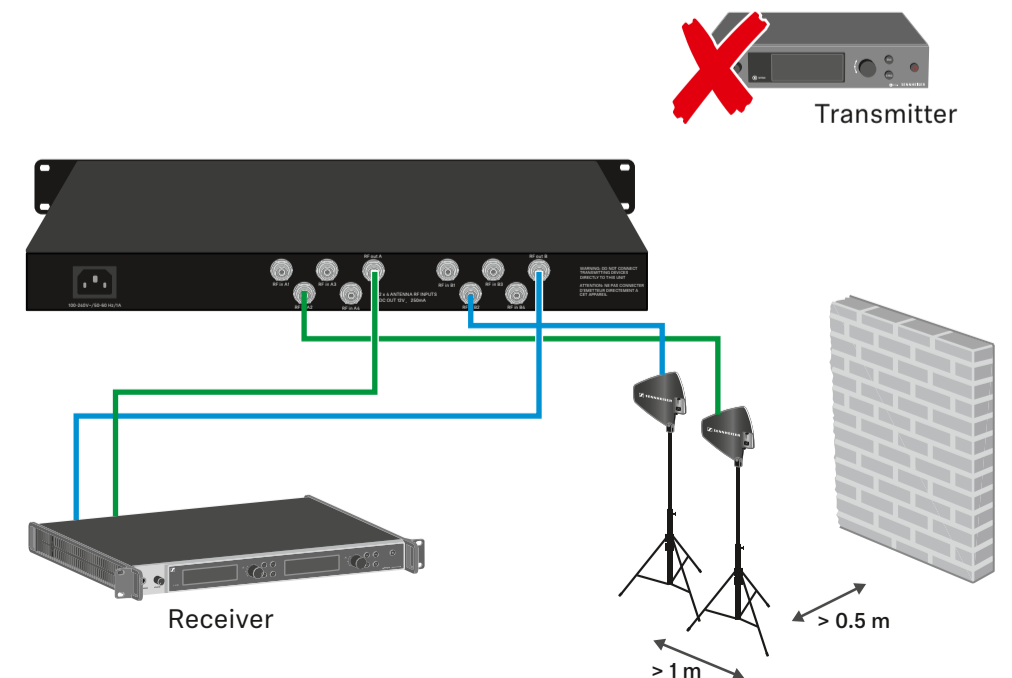

Example 1: Studio Complex

- RF IN A1 - A4
- RF IN B1 - B4

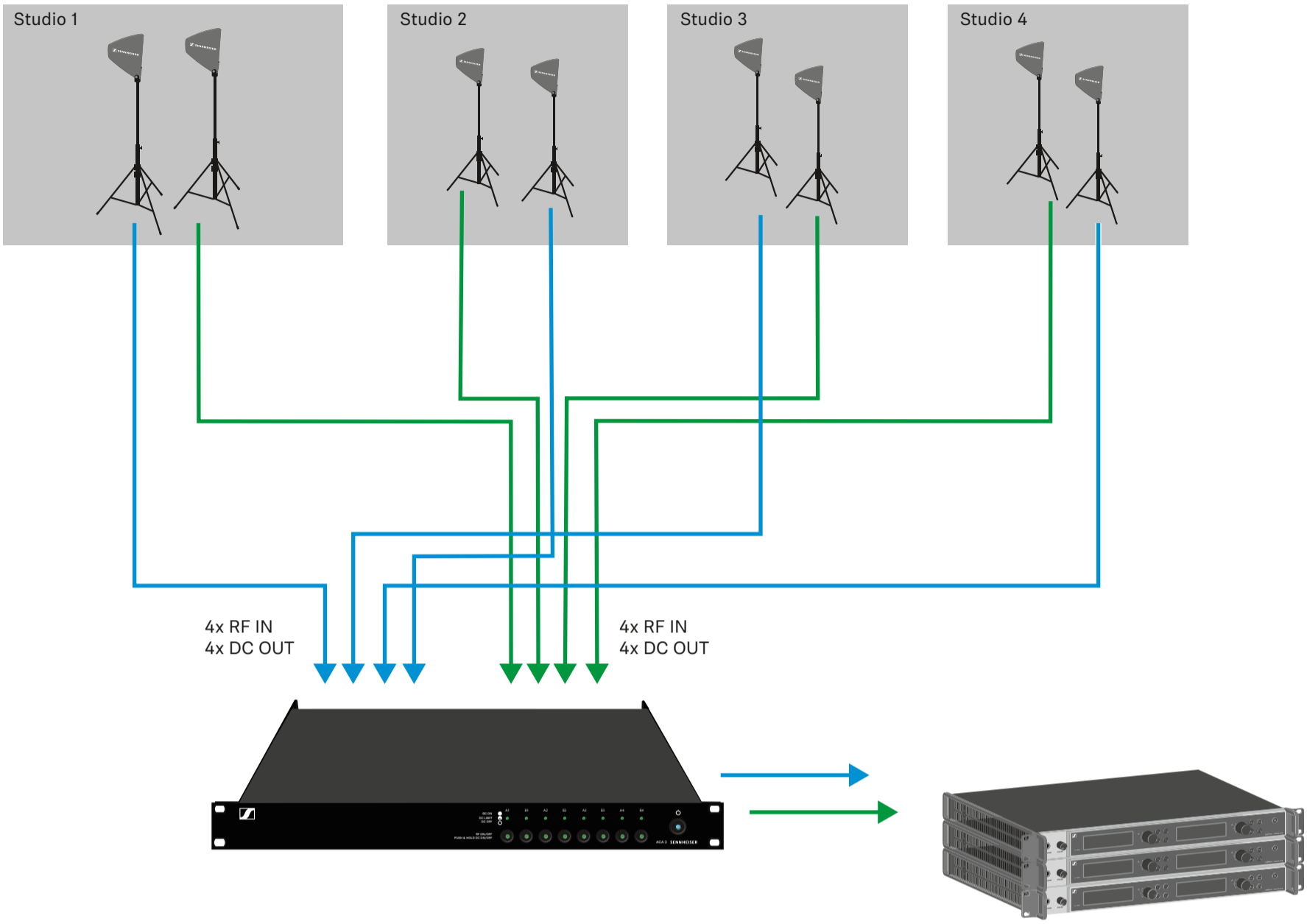

Example 2: Large Church

- RF IN A1 - A4
- RF IN B1 - B4

